

TWO STAGE PNEUMATIC CYLINDERS, LOPROfile® SERIES B-DA-SE-TS-SP-EM
 Double Acting-Single Ended Pistons-Two Stage-Side Ported-End Mounted

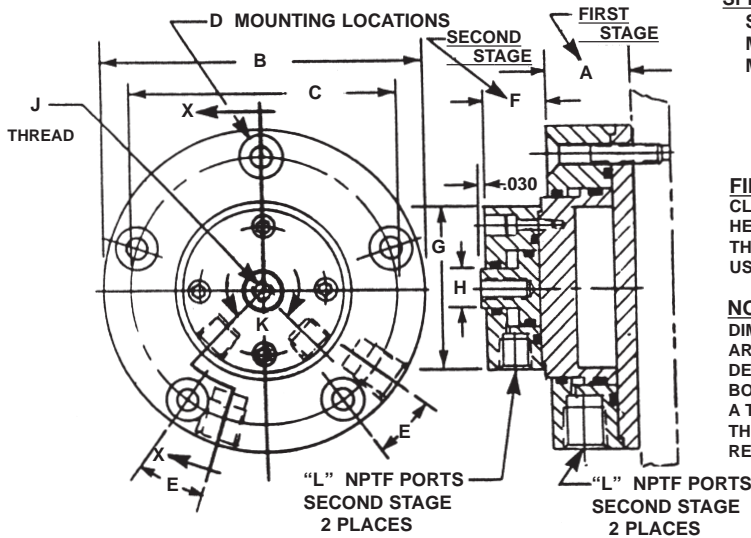

SPECIFICATIONS:

SERVICE: PLANT AIR
 M.O.P. 150 P.S.I.
 MATERIALS:
 BODIES, ALUMINUM ALLOY
 COVERS, ALUMINUM ALLOY
 PISTONS, STAINLESS STEEL
 FASTENERS, ALLOY STEEL

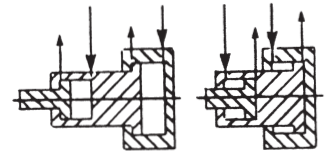

PICTORIAL

FIRST STAGE MOUNTING:

CLEARANCE HOLES WITH COUNTERSINKS FOR #10-32 FLAT HD. INT. SOCK. HEAD SCREWS ARE USED FOR STROKES THRU 0.500. #10-32 INTERNAL THREADED HOLES IN BOTH FRONT AND REAR MOUNTING SURFACES ARE USED FOR STROKES OF 1.000 INCH PLEASE SEE OPTIONAL MOUNTING.

NOTE:

DIMENSIONS ARE NOMINAL IN U.S. CUSTOMARY UNITS. METRIC VERSIONS ARE DIMENSIONALLY EQUIVALENT EXCEPT FOR CONVERSION IN MOUNTING DETAILS WHERE FASTENERS, THREADS, CLEARANCE HOLES AND COUNTERBORES ARE TO METRIC STANDARDS. PLEASE SEE INSIDE REAR COVER FOR A TABLE OF U.S. CUSTOMARY TO METRIC FASTENER CONVERSION. THERE IS NO ADDED COST FOR THIS METRIC VERSION. ALL INQUIRIES REGARDING OTHER MODIFICATIONS TO STANDARD CYLINDERS ARE WELCOME.

NOTE: FORCE (LB)=AREA (SQ.IN.) TIMES PRESSURE (PSI)

PART NUMBER S1911 -1-1 IS SHOWN WITH BOTH STAGES RETRACTED

FIRST STAGE DATA

SECOND STAGE DATA

BASIC PART NUMBER	STROKE	FIRST STAGE DATA					EXT. AREA (sq.in.)	RETR. AREA (sq.in.)	SECOND STAGE DATA						EXT. AREA (sq.in.)	RETR. AREA (sq.in.)	
		A	B	C	D	E			STROKE	F	G	H	J	K			L
S1911-1-1	0.100	0.781						0.100	0.588								
S1911-1-5	0.100	0.781						0.500	0.988								
S1911-1-10	0.100	0.781						1.000	1.488								
S1911-5-1	0.500	1.181						0.100	0.588								
S1911-5-5	0.500	1.181	3.000	2.500	5	18	2.540	0.320	0.500	0.988	1.500	0.375	#10-32	90	1/16	0.385	0.275
S1911-5-10	0.500	1.181							1.000	1.488							NPTF
S1911-10-1	1.000	1.681							0.100	0.588							
S1911-10-5	1.000	1.681							0.500	0.988							
S1911-10-10	1.000	1.681							1.000	1.488							
S1912-1-1	0.100	0.875							0.100	0.588							
S1912-1-5	0.100	0.875							0.500	0.988							
S1912-1-10	0.100	0.875							1.000	1.488							
S1912-5-1	0.500	1.275							0.100	0.588							
S1912-5-5	0.500	1.275	4.000	3.500	6	15	6.150	0.750	0.500	0.988	2.500	0.625	5/16-24	90	1/16	2.270	1.963
S1912-5-10	0.500	1.275							1.000	1.488							NPTF
S1912-10-1	1.000	1.775							0.100	0.588							
S1912-10-5	1.000	1.775							0.500	0.988							
S1912-10-10	1.000	1.775							1.000	1.438							

HOW TO ORDER CYLINDERS WITH OPTIONS:

ADD OPTIONS TO THE BASIC PART NUMBER AS SUFFIXES IN ANY ORDER.

EXAMPLE = S1911-1-1 - ETW



HOW TO ORDER METRIC VERSIONS:

SEE NOTE FOR DESCRIPTION OF A METRIC VERSION. A BASIC PART NO. FOR A METRIC VERSION CONSISTS OF ADDING THE PREFIX "M" TO A PART NO. FROM THE TABLE AND A SUFFIX DEFINING BOTH STROKES IN MILLIMETERS. THE FIRST SUFFIX TO DEFINE THE STROKE OF THE FIRST STAGE.

EXAMPLE =M S1911 - 2.5mm - 2.5mm



HOW TO ORDER BUNA "N" SERVICE KITS:

SPECIFY THE BASIC PART NO. FOLLOWED BY SUFFIX -SK

EXAMPLE = S1911-1-1-SK



OPTIONAL MOUNTING STYLE - FIRST STAGE

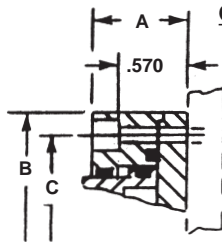

CLEARANCE HOLES WITH C'BORES FOR #10-32 INT. SOCK. HD. CAP SCREWS AT "D" PLACES. ADD SUFFIX -CBB TO A BASIC PART NUMBER. THERE IS NO ADDED COST.

OPTIONAL ROD ENDS-SECOND STAGE

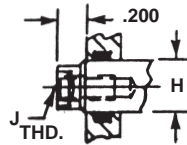

INTERNAL THREAD WITH WRENCH FLATS. ADD SUFFIX -ITW TO A BASIC PART NO. ADD 5% TO THE BASE PRICE.

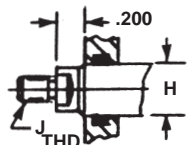

EXTERNAL THREAD WITH WRENCH FLATS. ADD SUFFIX -ETW TO A BASIC PART NO. ADD 8% TO THE BASE PRICE.

