

B·A·S·E® MICRO GRIPPERS - SERIES 3

BASIC MICRO GRIPPERS - WITHOUT FINGERS

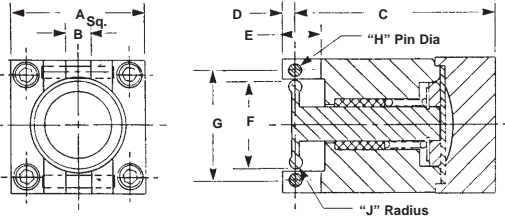

"K"=Effective diaphragm area in sq. inches.
 "L"=Unit weight in ounces.
 Stem Travel is 0.100 inch, Nom.
 See fitting location & mounting options.

Part No.	A	B	C	D	E	F	G	H	J	K	L
4765 - ()	1.000	0.188	1.462	0.095	0.278	0.600	0.800	0.094	0.047	0.300	2.0
4766 - ()	0.875	0.125	1.406	0.095	0.252	0.508	0.680	0.094	0.047	0.190	1.5
4767 - ()	0.750	0.125	1.206	0.082	0.202	0.446	0.600	0.063	0.031	0.106	1.1
4768 - ()	0.625	0.125	1.138	0.072	0.187	0.376	0.500	0.063	0.031	0.074	0.6
4769 - ()	0.500	0.094	1.077	0.075	0.174	0.260	0.376	0.063	0.031	0.046	0.4

MICRO GRIPPERS WITH BLANK FINGERS

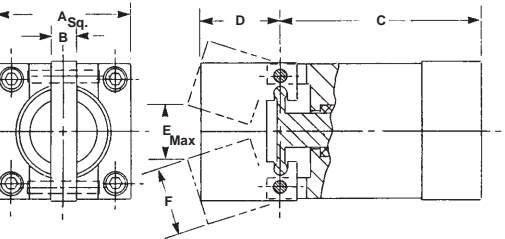

"G"=Gripper Weight in ounces.
 "H"=Pinch force in pounds at tip under spring closing force.
 "J"=Finger Rotation in degrees.
 See uppermost view & table for dimensions not shown
 See fitting location & mounting options.

Part No.	A	B	C	D	E	F	G	H	J
4770 - ()	1.000	0.188	1.462	0.566	0.420	0.500	2.0	2.7	18
4771 - ()	0.875	0.125	1.406	0.490	0.380	0.438	1.5	1.8	20
4772 - ()	0.750	0.125	1.206	0.504	0.460	0.375	1.1	0.8	24
4773 - ()	0.625	0.125	1.138	0.432	0.480	0.313	0.6	0.6	28
4774 - ()	0.500	0.094	1.077	0.300	0.340	0.250	0.4	0.4	29

MICRO GRIPPERS WITH INTERNAL GRIPPING FINGERS

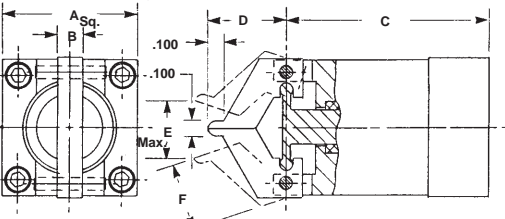

"G"=Gripper Weight in ounces.
 "H"=Pinch force in pounds at tip under spring closing force.
 "J"=Finger Rotation in degrees.
 See uppermost view & table for dimensions not shown
 See fitting location & mounting options.

Part No.	A	B	C	D	E	F	G	H	J
4775 - ()	1.000	0.188	1.462	0.566	0.420	0.500	2.0	2.7	18
4776 - ()	0.875	0.125	1.406	0.490	0.380	0.438	1.5	1.8	20
4777 - ()	0.750	0.125	1.206	0.504	0.460	0.375	1.1	0.8	24
4778 - ()	0.625	0.125	1.138	0.432	0.480	0.313	0.6	0.6	28
4779 - ()	0.500	0.094	1.077	0.300	0.340	0.250	0.4	0.4	29

MICRO GRIPPERS WITH EXTERNAL GRIPPING FINGERS

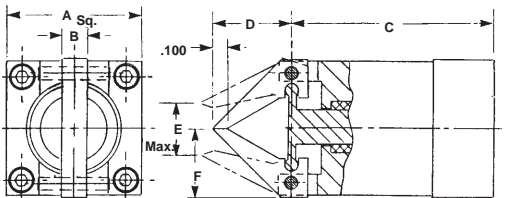

"G"=Gripper Weight in ounces.
 "H"=Pinch force in pounds at tip under spring closing force.
 "J"=Finger Rotation in degrees.
 See uppermost view & table for dimensions not shown
 See fitting location & mounting options.

Part No.	A	B	C	D	E	F	G	H	J
4780 - ()	1.000	0.188	1.462	0.566	0.420	0.500	2.0	2.7	18
4781 - ()	0.875	0.125	1.406	0.490	0.380	0.438	1.5	1.8	20
4782 - ()	0.750	0.125	1.206	0.504	0.460	0.375	1.1	0.8	24
4783 - ()	0.625	0.125	1.138	0.432	0.480	0.313	0.6	0.6	28
4784 - ()	0.500	0.094	1.077	0.300	0.340	0.250	0.4	0.4	29

FITTING LOCATION & MOUNTING CHOICES

USE SUFFIX "AF/SM" FOR THE AFT FITTING & SIDE MOUNTING CONFIGURATION SHOWN BELOW.

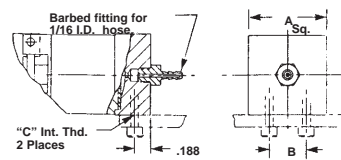

Configuration Identification	A	B	C
AF/SM	1.000	0.438	4-40
	0.875	0.375	4-40
	0.750	0.281	4-40
	0.625	0.226	2-56
	0.500	0.148	2-56

USE SUFFIX "AF/AM" FOR THE AFT FITTING & AFT MOUNTING CONFIGURATION SHOWN BELOW.

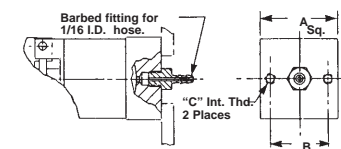

Configuration Identification	A	B	C
AF/AM	1.000	0.750	4-40
	0.875	0.625	4-40
	0.750	0.563	4-40
	0.625	0.438	2-56
	0.500	0.375	2-56

USE SUFFIX "SF/SM" FOR THE SIDE FITTING & SIDE MOUNTING CONFIGURATION SHOWN BELOW.

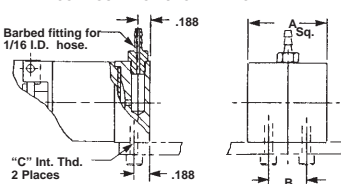

Configuration Identification	A	B	C
SF/SM	1.000	0.438	4-40
	0.875	0.375	4-40
	0.750	0.281	4-40
	0.625	0.226	2-56
	0.500	0.148	2-56

USE SUFFIX "SF/AM" FOR THE SIDE FITTING & AFT MOUNTING CONFIGURATION SHOWN BELOW.

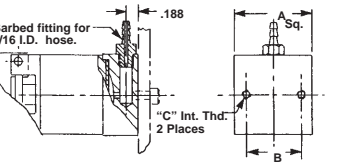

Configuration Identification	A	B	C
SF/AM	1.000	0.750	4-40
	0.875	0.625	4-40
	0.750	0.563	4-40
	0.625	0.438	2-56
	0.500	0.375	2-56

NOTES:
 Fingers may be oriented 90° relative to mounting holes by removing fasteners and rotating body sections relative to each other.

SCHEMATIC - Use three-way valve for control.

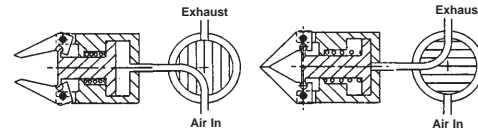

All micro grippers operate on the principle of single acting pneumatic cylinders controlled by a simple three-way valve circuit. Fingers open when air pressure is applied and close by spring force when pressure is exhausted.

Barbed fittings are supplied for 1/16" I.D. plastic hose.

SPECIFICATIONS:

MAX. OPER. PRESS., 150 PSI (10 BARS)
 MIN. OPER. PRESS., 60 PSI (4 BARS)
 MAX. OPER. TEMP., 150° F. (65° C.)

MATERIALS:

HOUSING & FINGERS, ALUM. ALLOY
 STEM & PINS, STAINLESS STEEL
 SPRING, MUSIC WIRE OR ST. STEEL
 FASTENERS, ALLOY STEEL I.S.H.C.S.
 FITTING, BRASS

HOW TO ORDER MICRO-GRIPPERS

A COMPLETE PART NUMBER consists of a four digit number followed by a suffix to indicate fitting location and mounting style. See fitting & mounting choices.

EXAMPLE= 4770 - AF/SM
 — Aft Fitting/Side Mounting
 — Four Digit Number From Tables

HOW TO ORDER ALL STAINLESS MICRO GRIPPERS

Add the letters "SS" as a prefix to the COMPLETE PART NUMBER. Add 50% to the BASE PRICE.

EXAMPLE= SS - 4770 - AF/SM
 — Complete Part Number
 — All Stainless Steel Prefix

